

Testing your Water for Lead

Address of property: _____ Zip: _____

Name of sampler: _____

1. Do not use any water for 6+ hours.

This can be done overnight or while away at work. You will collect your samples before flushing toilets, doing laundry, etc.

My water was last used on ____ / ____ / ____ at ____:____ am/pm.

2. Prepare to collect.

Go to your kitchen sink and write today's date. Place your first bottle underneath the tap to ensure you collect the water that first exits.

Collection Date: ____ / ____ / ____

3. Fill 1st bottle and leave water running.

Turn on your cold water at a normal water pressure. Fill first bottle completely and set to the side. Do not turn off the water. Write the time.

Bottle 1: Time ____:____ (am/pm)

4. Wait 45 seconds.

5. Fill 2nd bottle and leave water running.

Fill 2nd bottle completely & set to the side. Do not turn off the water. Write the time.

Bottle 2: Time ____:____ (am/pm)

6. Wait 3 minutes.

7. Fill 3rd bottle and turn water off.

Fill 3rd bottle completely & set to the side. Turn off water. Write the time.

Bottle 3: Time ____:____ (am/pm)

8. Place bottles & this sheet back into box.

9. Call for a kit pick up within 7 days.

Call or text (414) 286-2924. If you call, please leave a message that includes your address. Place the box on your front porch for an easy pick-up.

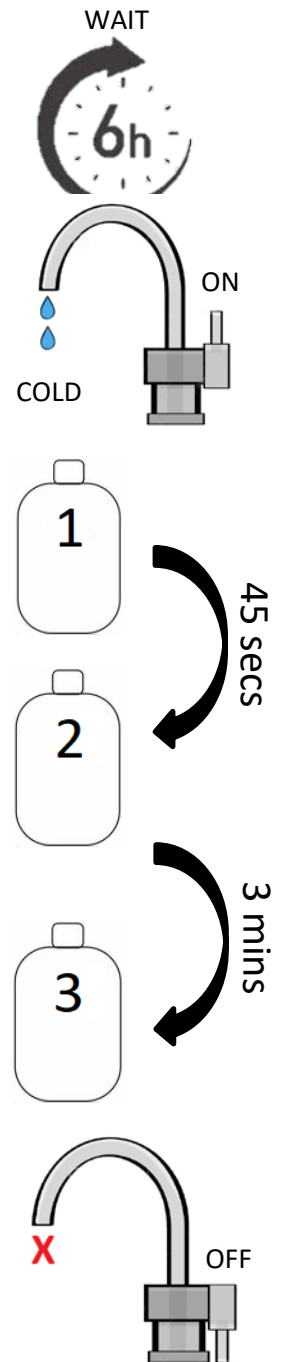

Thirsty for More Information?

Did you know that lead in drinking water typically comes from the lead pipes, faucets and plumbing fixtures that carry the water? That's why we ask you to let the water sit for at least 6 hours before collecting it. During this time, the water is able to sit and absorb any lead that may be present in the plumbing, so make sure to capture every drop as soon as you turn your faucet on! This allows us to provide you with the most accurate result.

Your water can tell us a lot about your plumbing! That's why we ask you to take your samples with a few seconds or minutes in between. This way, we know where each sample is coming from and can help us diagnose where you may have lead plumbing. This is also why it's important that your water be turned on at a *normal* water pressure, not too strong and not too weak! The graphic below shows where each sampling bottle is typically collecting water from.

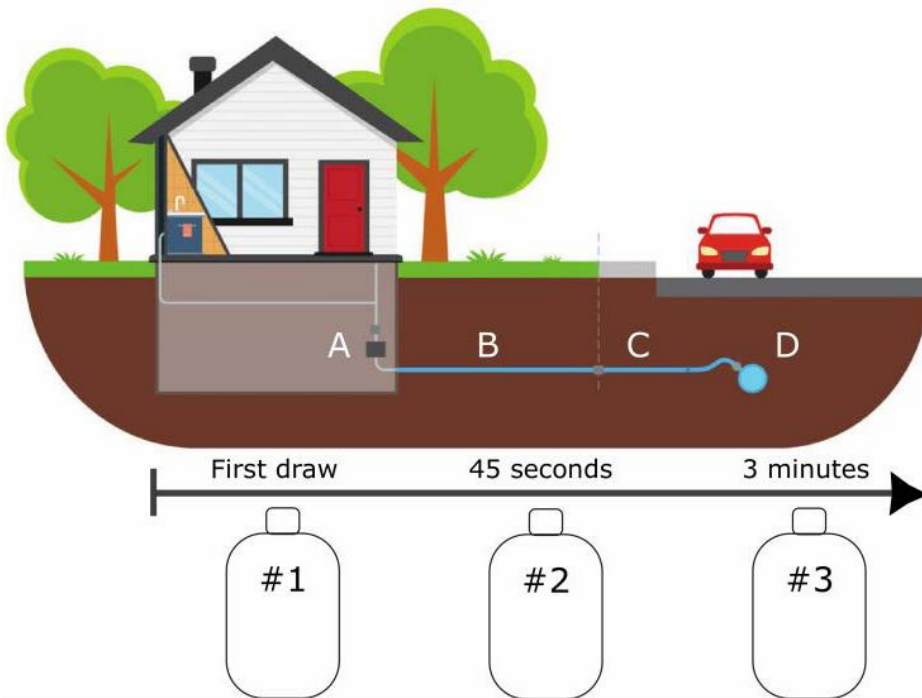

Bottle 1:

Collects the water sitting in your internal plumbing. That includes your faucet down to your water meter (A).

Bottle 2:

Collects water sitting in external plumbing. This includes your private service line (B) and the public service line (C).

Bottle 3:

Collects water directly from the public water main (D) in the street.

Always sample using cold water only! This is because cold water comes directly from the water main, through your service lines and plumbing to your faucet. Hot water, on the other hand, goes through your hot water heater which may contain contaminants not related to your water quality. We also always recommend drinking and cooking with only cold water.

If you have any further questions about the testing process, please call our Water Chemist Project Leader at 414-286-5415. If you would like to learn more about how Milwaukee Water Works prevents lead leaching, replaces lead service lines or purifies the City's water, please visit <https://city.milwaukee.gov/water>.