

ESTIMATE OF QUANTITIES
FOR BIDDING

- CEMENT ENCASED, 4-INCH RIGID NONMETALLIC CONDUIT, DB-60
 421 LIN FT - 6-DUCT CONDUIT PACKAGE
 47 LIN FT - 4-DUCT CONDUIT PACKAGE
 44 LIN FT - 2-DUCT CONDUIT PACKAGE
- INSTALLING CONDUIT INTO EXISTING ITEM
 11 EACH
- TRENCH RESTORATION
 40 50 YDS - 8" CONCRETE BASE
- FURNISH AND INSTALL DOWEL BARS
 177 - BARS
- SAWCUTTING
 354 LIN FT - 1" ASPHALT ON CONCRETE BASE (FULL DEPTH)

- PAVEMENT TYPE**
- GRIND EXISTING PAVEMENT &
 PLACE VARIABLE THICKNESS ASPHALTIC CONCRETE PAVEMENT
- ROAD LIFE
- E. LINCOLN AVE. - S. ROBINSON AVE. TO S. HOWELL AVE.
 1989 - VARIABLE THICKNESS ASPHALT CONCRETE SURFACE ON
 1956 - 3" SHEET ASPHALT ON 8" CONCRETE BASE
 INTERSECTION OF E. LINCOLN AVE. & S. HOWELL AVE.
 1956 - (EXCEPT EBW) 3" ASPHALT CONCRETE ON
 1959 - VARIABLE THICKNESS ASPHALTIC CONCRETE SURFACE ON
 1929 - 3" SHEET ASPHALT ON 8" CONCRETE BASE
 E. LINCOLN AVE. - S. HOWELL AVE. TO S. ALLIS ST./S. KINNICKINNIC AVE.
 1959 - VARIABLE THICKNESS ASPHALT CONCRETE SURFACE ON
 1929 - 3" SHEET ASPHALT ON 8" CONCRETE BASE
 INTERSECTION OF E. LINCOLN AVE. & S. ALLIS ST./S. KINNICKINNIC AVE.
 1959 - (EXCEPT E.1/3) VARIABLE THICKNESS ASPHALTIC CONCRETE SURFACE ON
 1954 - VARIABLE THICKNESS SHEET ASPHALT RESURFACE ON
 1924 - 8" VIBROLITHIC CONCRETE

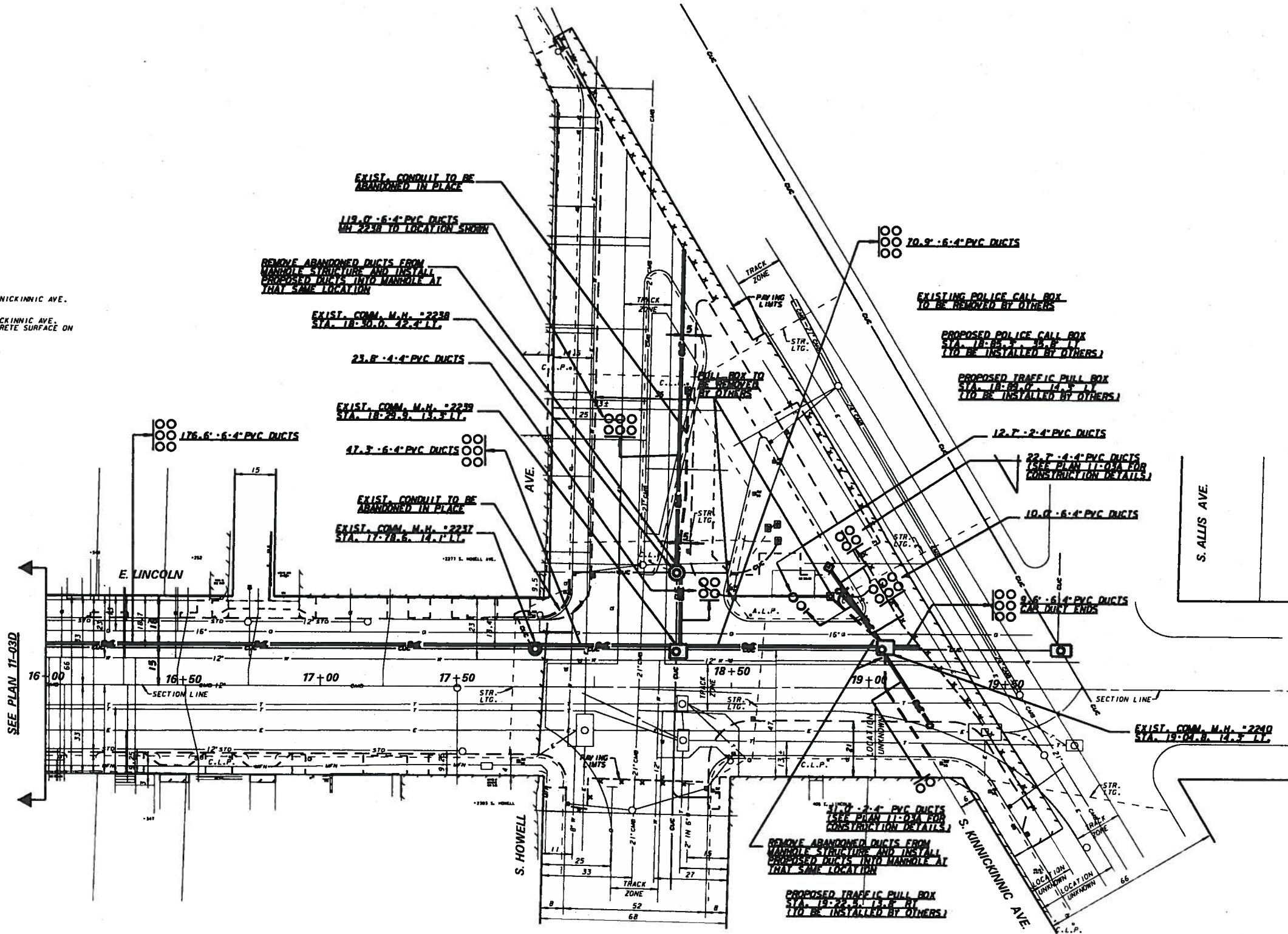

SEE PLAN 11-03D

PLAN FILE NO. 11-03E
 ALD. DIST. 14
 BK 1 P
 BK 2 P 69 & 71

TRANSPORTATION SECTION
 INFRASTRUCTURE SERVICES DIVISION
 DEPARTMENT OF PUBLIC WORKS
 MILWAUKEE, WISCONSIN

UNDERGROUND CONDUIT PLAN

E. LINCOLN AVENUE
 180' WEST OF S. HOWELL AVENUE
 S. KINNICKINNIC AVENUE

DATE: _____

SCALE: HORIZ. 1" = 20'
 VERT. 1" = 10'

DESIGN NO. 456 & 499
 PLAN DATE: 2/10/11
 DRAWN BY: SALAPAZ/STUBER
 CHECKED BY: S.J.S.
 DESIGNED BY: K.L.R.

APPROVED: _____ DATE: _____
 TRANSPORTATION SECTION MANAGER

CITY ENGINEER & SPECIAL DEPUTY COMMISSIONER OF PUBLIC WORKS

FIG. NO. ST200100204

SHEET NO. 5 OF 5 PLAN FILE NO. 11-03E

LINE CODE LEGEND			
GAS	---	SANITARY SEWER	---
ELECTRIC	---	STORM SEWER	---
TELEPHONE	---	COMBINED SEWER	---
CABLE TELEVISION	---	SEW DISTRIC SEWER	---
FIBER OPTICS	---	WATER MAIN	---
	---	SEWERWATER OVER 24"	---
STREET LIGHTING	---	COMMUNICATION	---
ELECTRICAL SERVICES	---	PAVING LIMITS	---
STRUCTURE BUILDING	---	FENCE	---

LEGEND

PROPOSED CITY UNDERGROUND CONDUIT

EXISTING CITY UNDERGROUND CONDUIT

ASPHALT PAVING LIMITS

CALL DIGGERS HOTLINE
 1-800-242-8511

BEFORE YOU DIG, BEWARE OF UNDERGROUND UTILITIES. CALL 1-800-242-8511 BEFORE YOU DIG.

